

516
1/2

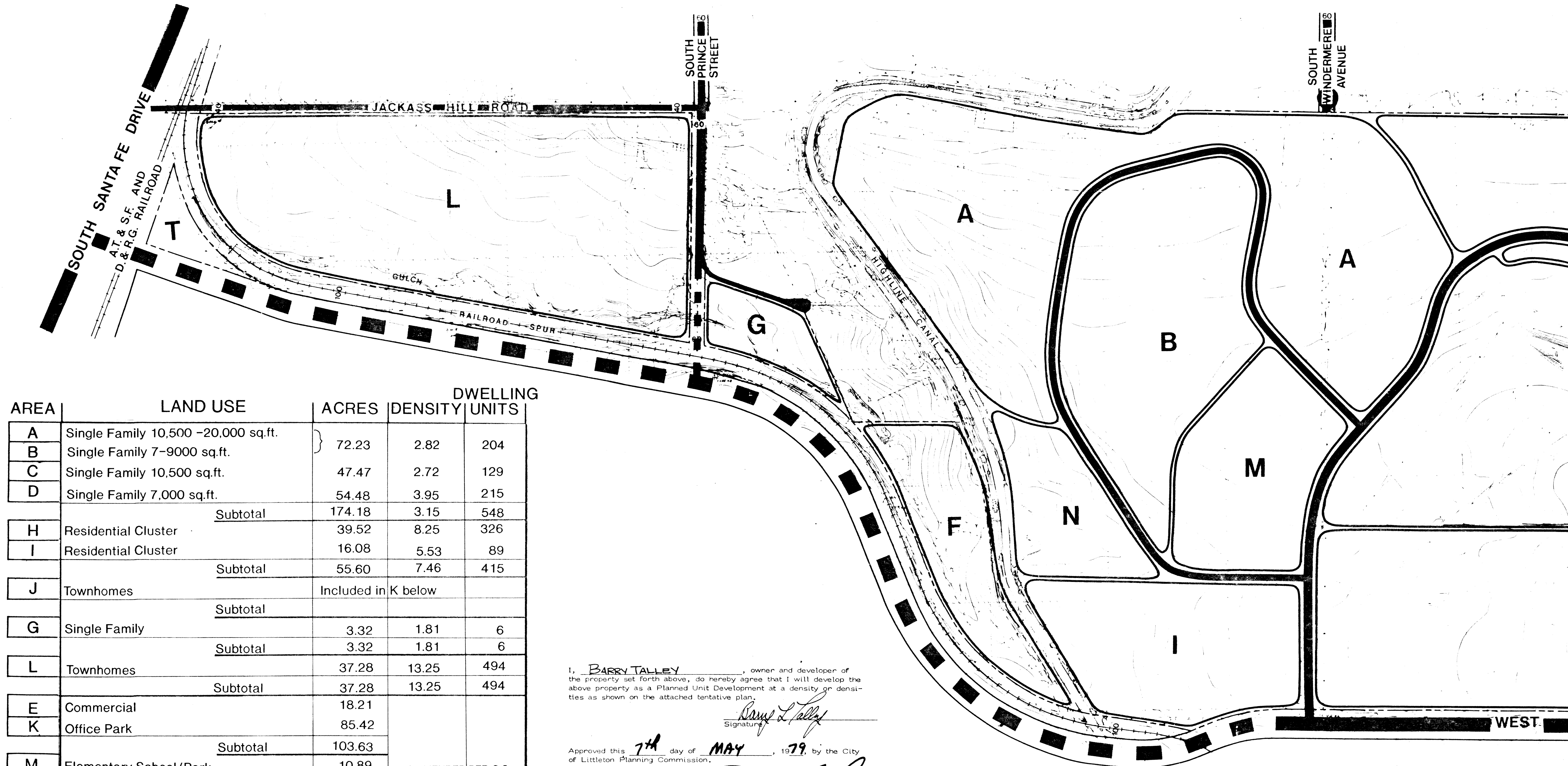

AREA	LAND USE	ACRES	DENSITY	DWELLING UNITS
A	Single Family 10,500 -20,000 sq.ft.	72.23	2.82	204
B	Single Family 7-9000 sq.ft.			
C	Single Family 10,500 sq.ft.			
D	Single Family 7,000 sq.ft.			
	Subtotal	174.18	3.15	548
H	Residential Cluster	39.52	8.25	326
I	Residential Cluster	16.08	5.53	89
	Subtotal	55.60	7.46	415
J	Townhomes	Included in K below		
	Subtotal			
G	Single Family	3.32	1.81	6
	Subtotal	3.32	1.81	6
L	Townhomes	37.28	13.25	494
	Subtotal	37.28	13.25	494
E	Commercial	18.21	AS AMENDED PER C.C. RESOLUTION 83-5, FEBRUARY 1, 1983	
K	Office Park	85.42		
	Subtotal	103.63		
M	Elementary School/Park	10.89		
N	Community Club	6.32		
O	Park	15.31		
P	Park-Drainage	9.05		
F	Equestrian Center	7.71		
R	Open Space	12.53		
T	Future Development	1.57		
	Subtotal	63.38		
TOTAL		437.42	3.34	1463

TOTAL DENSITY

Gross density of Area to Rezone $\frac{1104 \text{ units}}{388.66 \text{ acres}} = 2.8 \text{ units per acre}$

Gross Density of Total PUD $\frac{1555 \text{ units}}{437.42 \text{ acres}} = 3.55 \text{ units per acre}$

I, BARRY TALLEY, owner and developer of the property set forth above, do hereby agree that I will develop the above property as a Planned Unit Development at a density or densities as shown on the attached tentative plan.

Barry Talley
Signature

Approved this 7th day of MAY, 1979, by the City of Littleton Planning Commission.

Dennis M. R.
Chairman

Approved this 6 day of MAY, 1979, by the City Council of the City of Littleton.

Sally Parsons
Council President

Attest:
Janet R. Harrison
City Clerk

SOUTHBRID LITTLETON, COLORADO

SANTA FE LAND IMPROVEMENT COMPANY - OWNER
U.S. HOMES CORPORATION, WITHIN DIVISION - DEVELOPER

516
2/2

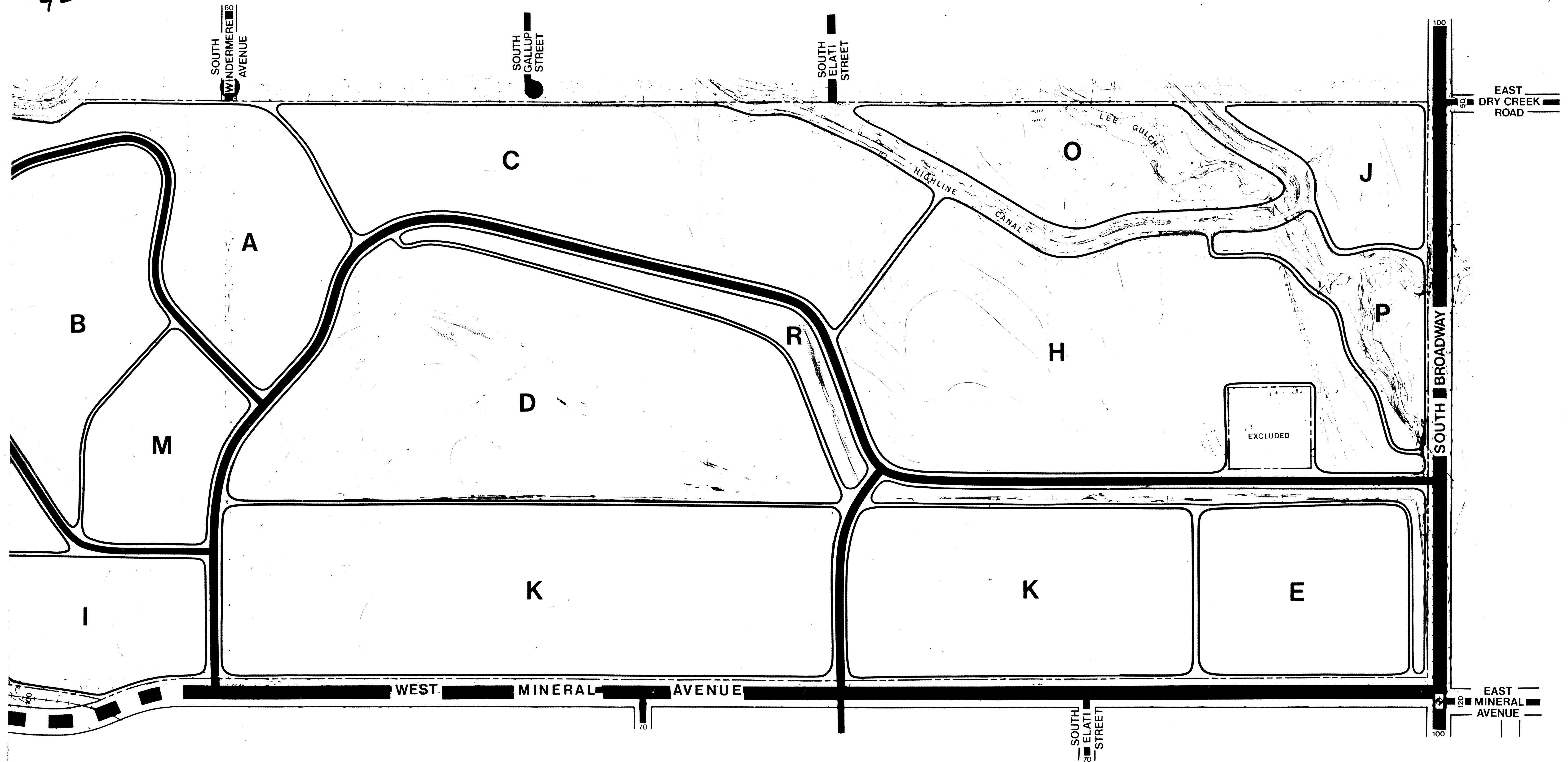

SOUTHBRIDGE TLETON, COLORADO

FE LAND IMPROVEMENT COMPANY — OWNER
MES CORPORATION, WITKIN DIVISION — DEVELOPER

tentative plan

th

associates, inc.
1601 emerson street
denver, colorado 80218
(303) 832-5417

Date 11-13-78

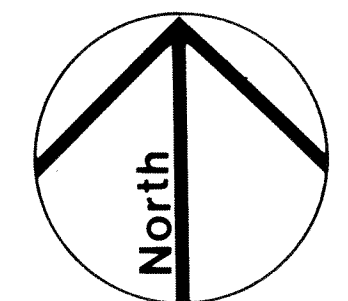

0 100 200 400
Scale 1"=200'