

LITTLETON MUSEUM: HISTORY GALLERY REVISIONING & EXPANSION

Tim Nimz, Museum Director

Seth Frankel, Principal – Studio Tectonic

MAY 20, 2025



HISTORY EXHIBIT AT THE LITTLETON MUSEUM



- **2005:** Littleton Museum expansion/renovation opens including *Spirit of Community* history exhibit
- No extensive updating since the history exhibit opened
- **2022:** Community engagement revealed a desire to retain traditional histories and a strong need to add untold stories of under-represented groups and communities
- **2024:** Additional focus groups confirmed need to update exhibit and add untold stories

Road to Revisioning: Planned Project Timeline

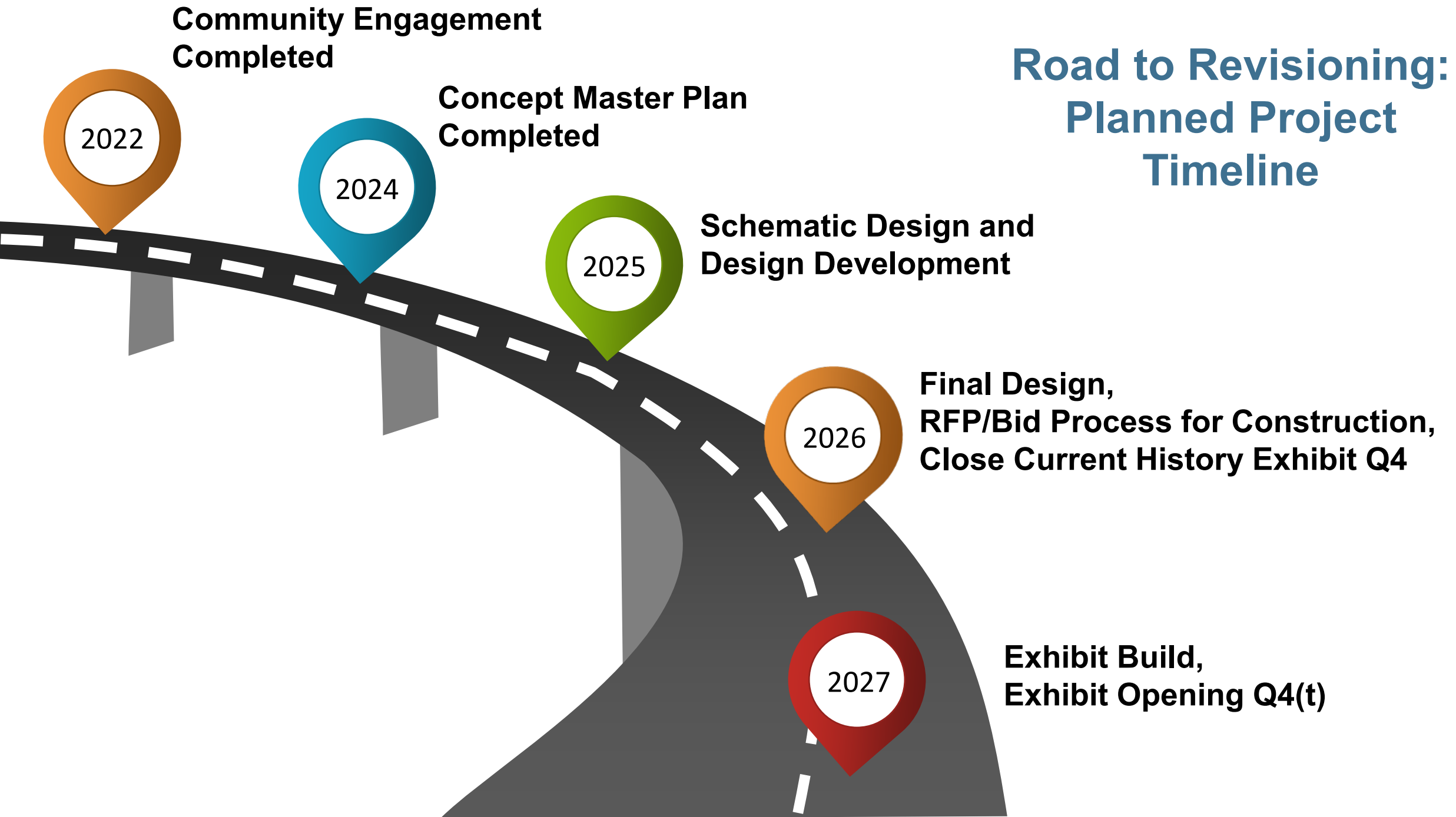

CONCEPT MASTER PLAN

Process

- In 2024, Studio Tectonic was selected to create a concept master plan for the history gallery revisioning and expansion
- Site visits to area museums
- Focus groups and discovery meetings conducted by Studio Tectonic with community and stakeholders
- Timeline Towers and Thematic Nodes established in collaboration with Museum staff
- Preliminary artifacts and storylines identified in collaboration with Museum staff
- Concept Master Plan delivered in January 2025

CONCEPT MASTER PLAN

Outcome

Visitor flow based around Timeline Towers and Thematic Nodes highlighting Littleton's people and their stories

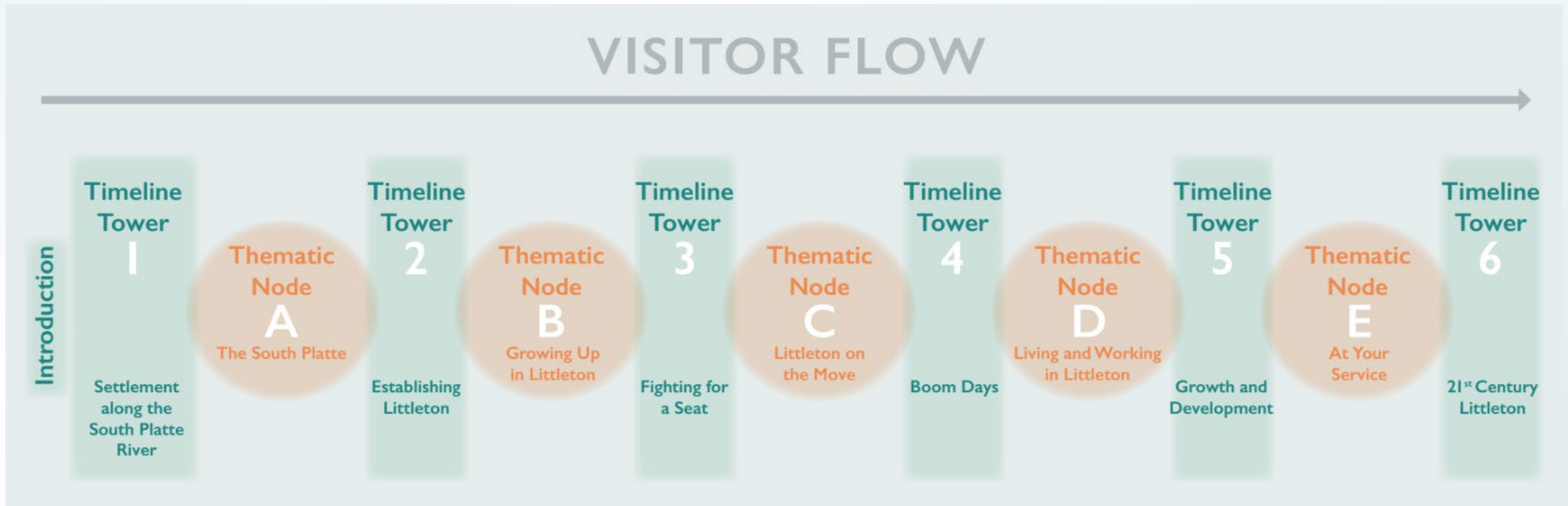

CONCEPTUAL FLOORPLAN

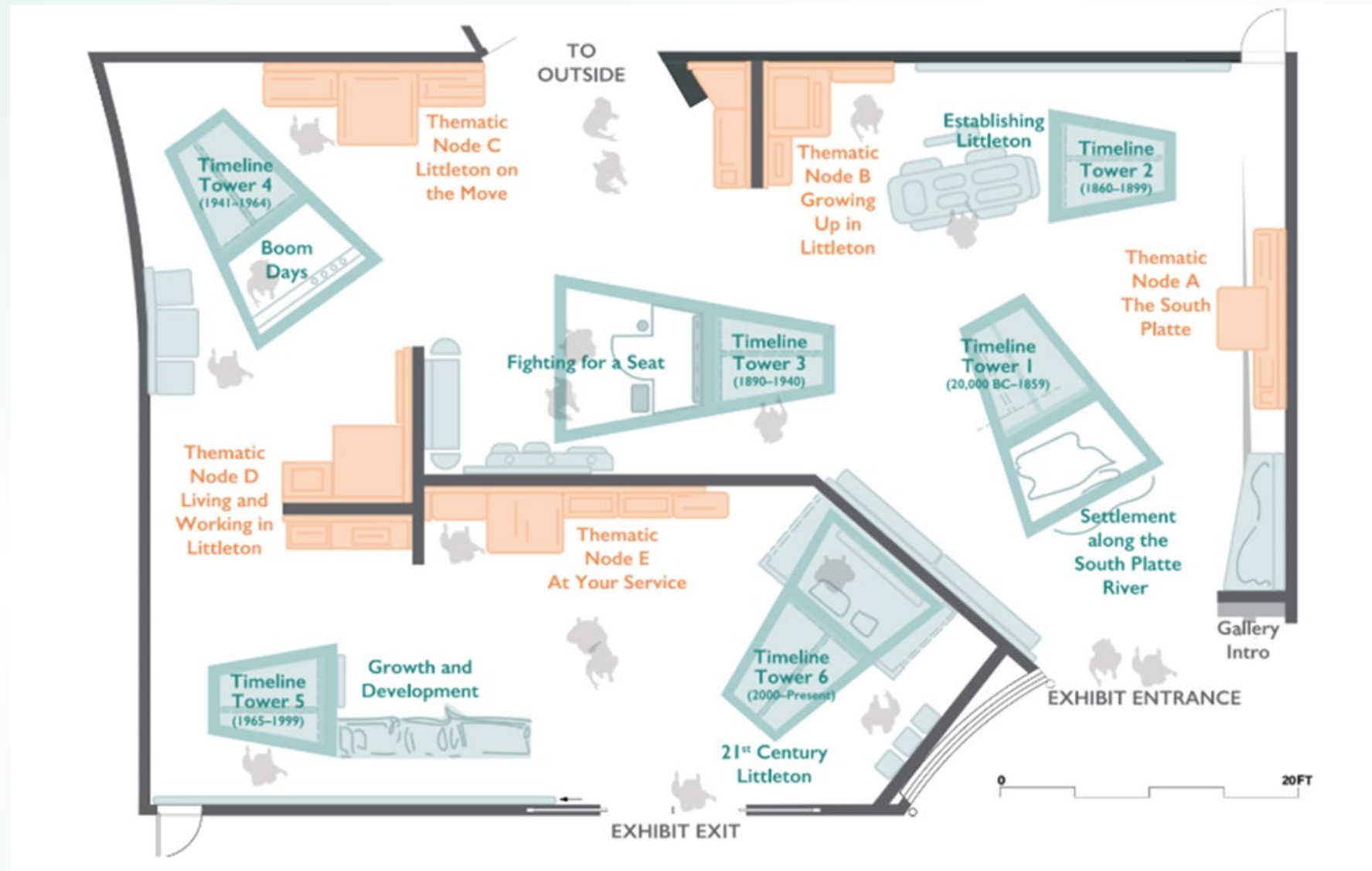

A CLOSER LOOK AT TIMELINE TOWER 1 OF 6

7

Timeline Tower 1 — Settlement Along the South Platte River (20,000 BC–1859)



Settlement Along the South Platte River (20,000 BC–1859)

Parfleche

This parfleche may be from the Kiowa tribe.



Miner's Pan

Sluice pans were used by prospectors early in Colorado's gold rush as an easy way to locate gold in placer deposits.

Bench

This section of log was taken from John McBroom's cabin, and later made into a bench around 1858.



Tools

Mining, farming, ranching, blacksmithing, etc.



Depth/ Breadth Collections



Timeline Key Collections/ Displays/ Interactives



Time Period Scenic Element

Area Big Idea

- Preceding the discovery of gold in Cherry Creek was a **Littleton of the past that was rich with life, human experiences, and periods** that set the foundation for the community of Littleton today. These past moments still resonate with our lived experiences.

Early History



A CLOSER LOOK AT TIMELINE TOWER 2 OF 6

8

Timeline Tower 2 — Establishing Littleton (1860–1889)



Establishing Littleton (1860–1889)

Bust of Richard Little
"Richard S. Little 1829-1899 Founder of Littleton, homesteaded area 1862, platted town 1872."



Newspaper
Vol. 1, No. 1 of the Littleton Gazette, Littleton's first newspaper; 1888.

Coffee Mill
Manual burr-mill coffee grinders were used in American homes from c.1895 to c.1930.



Hats/Hatpins or luggage from the era



Depth/ Breadth Collections



Timeline Key Collections/ Displays/ Interactives



Time Period Scenic Element

Area Big Idea

- The area began to transition from a collection of farms and homesteads to a town when homesteader Richard Little subdivided and platted his land, laying the foundation for Littleton. The **arrival of the railroad**, which carried crops from area farms to growing cities like Denver, helped ensure the fledgling town's success.

Railroads arrive in Littleton



A CLOSER LOOK AT THEMATIC NODE A

Thematic Node A — Littleton's Lifblood: The South Platte River



THEMATIC NODE A – HIGH ENGAGEMENT ELEMENT

Thematic Node A — Littleton's Lifeblood: The South Platte River

High Engagement Element—IRRIGATION

Visitors learn about the importance of irrigation through a playful interactive. They may use the small head-gate wheel to raise and lower small, model headgates. The wheel changes the flow on the video screen and shows how Littleton's water users send the resource to different needs.

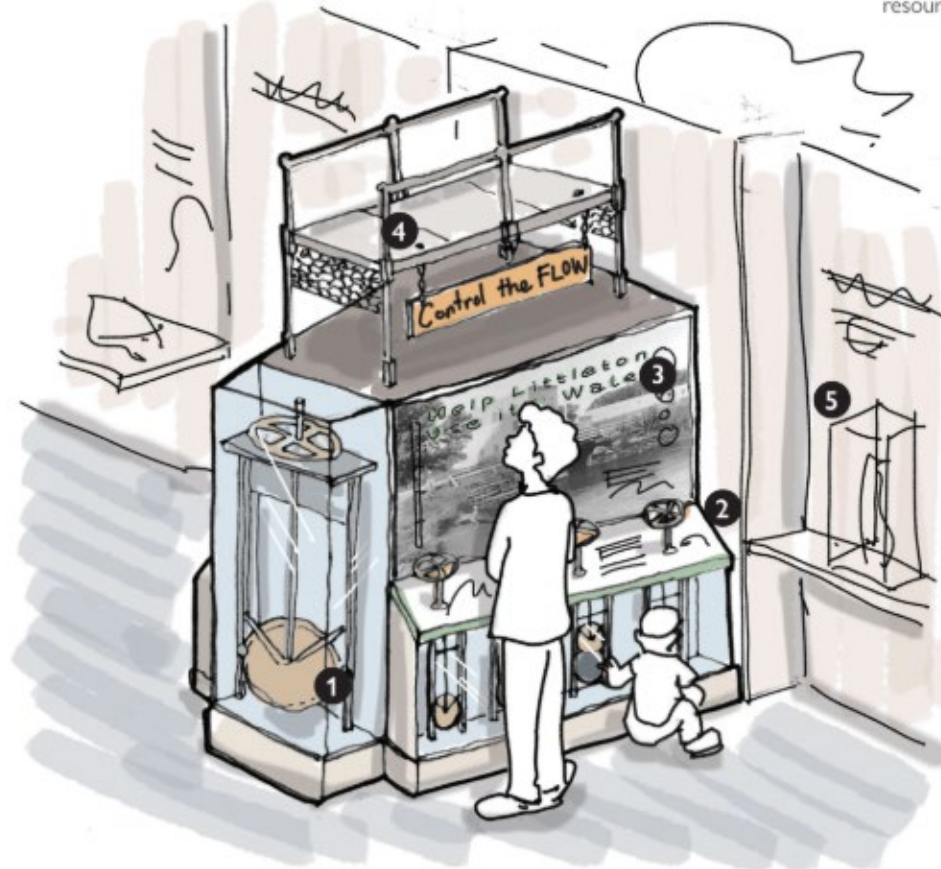

- 1 Historical artifact anchors the exhibit area
- 2 Interactive stations raise and lower the slide gates, revealing the pipes, perhaps with surprises and lighting inside
- 3 Video screen interactive shows how opening and closing the gates change the water supply
- 4 Irrigation equipment overhead create feel of a head-gate location
- 5 Adjacent exhibits focus on the South Platte River

PROJECT FUNDING

Year	Project Phase	Approved Funding Sources
2022	Community Engagement	Bequest to Littleton Museum
2024	Concept Master Plan	Conservation Trust Fund
2025 - 2027	Design through Build Completion	Grant, Impact Fees



WHAT'S NEXT?

With approval of Studio Tectonic's Contract for the design phases:

- Schematic Design - 2025
- Continued Community Engagement - 2025
- Design Development - 2025-2026
- Final Design - 2026
- RFPs and Bid Process for Construction - 2026 Q4
- Closure of Current History Exhibit - 2026 Q4
- Building of New Exhibit - 2027
- Opening of New Exhibit - 2027 Q4(t)



Questions?

